

Did you know that H&K Norwood sells Steamer Replacement Parts?

* Items highlighted in red are the most commonly replaced parts

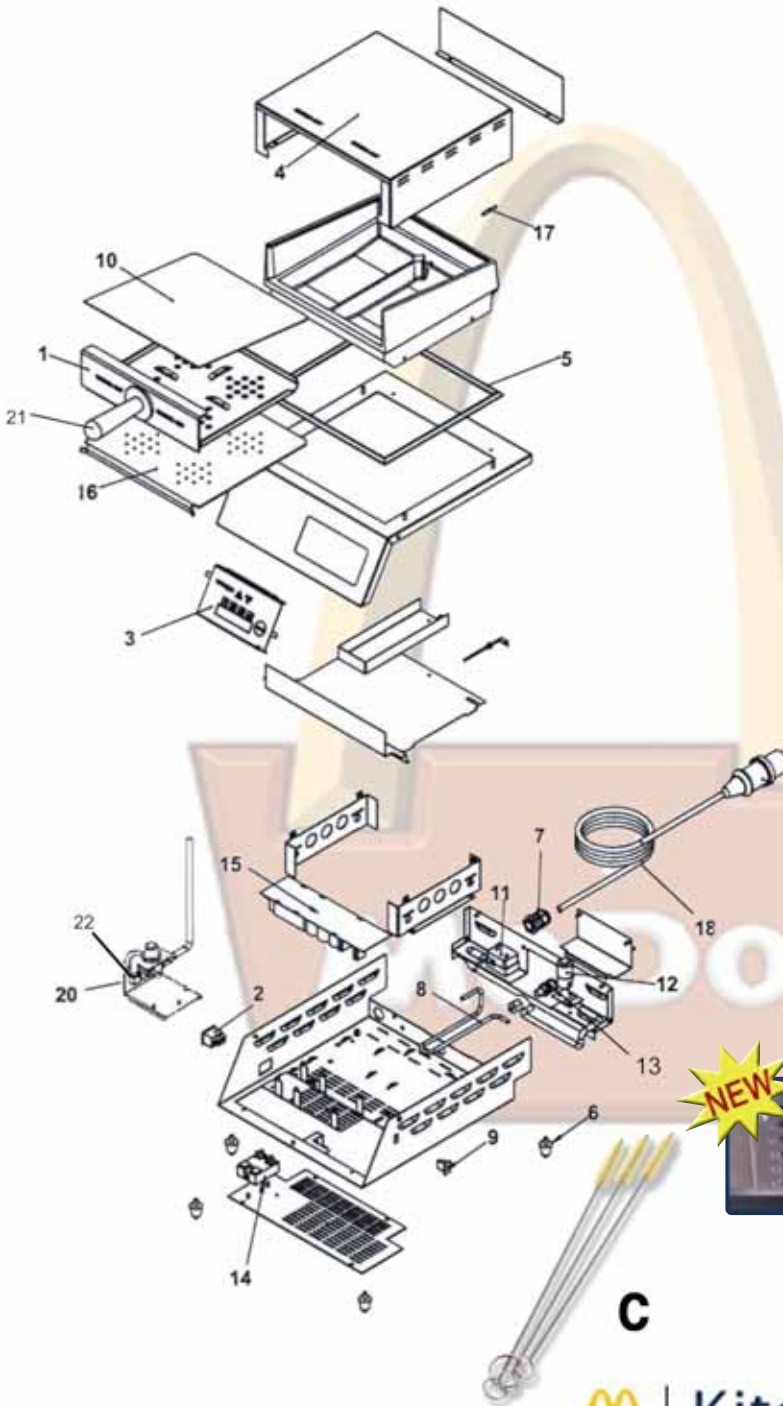

Ref	Part No.	Description
-----	----------	-------------

A	625-MFY	Prince Castle Rapid Steamer
B	625-320S	Backplate *** New ***
C	3BR	Set of 3 Steamer Water Tube Brushes
1.	625-128S	Spatula Assembly
2.	78-233S	Power Switch, 20A
3.	625-193S	Membrane Switch Assy
4.	625-158S	Cover, Top
5.	625-130S	Gasket, Silicone
6.	197-232	Feet (Pack of 4)
7.	66-045S	Strain Relief f/Power Cord
8.	625-197S	Water Dispensing Tube Kit
9.	88-497S	Mini-Jack, K-Type
10.	625-064S	Top Plate
11.	625-207S	Hi-Limit Thermostat
12.	625-319S	Water Valve Assy *** New ***
13.	625-318S	Water Valve Connector
14.	65-059S	Relay, 40A
15.	625-323S	PC Power Board
16.	625-065S	Venturi Plate
17.	625-082S	Probe, 1000 Ohm RTD
18.	72-386S	Line Cord Assy
20.	625-253S	Regulator Assy Kit
21.	625-097S	Spatula Handle Kit
22.	86-359S	Male Quick Disconnect Fitting
	86-365S	Water Strainer Body
	625-204S	Display/Control Board
	625-196S	Platen Bushing
	625-324S	O-rings For Male Quick Disconnect (Pkg of 5)

NEW

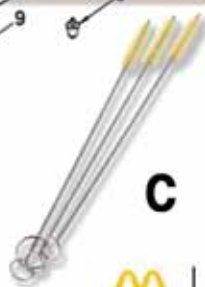

 | Kitchen 24

Order Online at mcd.kitchen24.com

PRINCE CASTLE INC. WORLDWIDE 

 **H&K Norwood** To Order Phone 800.521.3987
Your Equipment Solution Fax 248.293.5113 Email: SalesHKN@hkdallas.com

McDonald's
Steamer Replacement Parts
Order Form



National Unit No. Licensee McOpCo

Ship to: _____

Address: _____

City: _____

State: _____

Phone: _____

Ordered By: _____

Region: _____

Bill To (if different than ship to): _____

Address: _____

City: _____

State: _____

Phone: _____

Email Address: _____



We Accept Visa and MasterCard



Please check one:

Visa

MasterCard

Invoice "Bill To" Account

Credit Card Account Number:

Exp. Date:

Signature: _____

Date: _____

Ordered by (Name as it appears on card): _____

H&K Norwood Part Number	Item Description	What it does/When to replace	Price** (Each)	QTY Ordered
A 625-MFY	Prince Castle Rapid Steamer		\$ 961.25	
B 625-320S	Backplate ** NEW **	New vented backplate improves efficiency by allowing hot air to escape from the internal components of the steamer	\$ 14.76	
C 3BR	Set of 3 Water Tube Brushes	Brushes used to assist in the removal of scale build up in the water tube	\$ 6.42	
1 625-128S	Spatula Assembly	Replace when spatula is severely dented and cannot be placed back into chamber, Clear Non Stick	\$ 66.00	
2 78-233S	Power Switch	Replace when broken, a symptom would be when the unit receives power but does not work	\$ 8.37	
3 625-193S	Membrane Switch Assembly	Where start button is located. Replace when overlay has been torn or damaged but control board is in good condition	\$ 83.52	
4 625-158S	Top Cover	Replace when lost or damaged	\$ 50.16	
5 625-130S	Silicone Gasket	Gasket seals the platen to the base. Replace if worn due to excessive cleaning	\$ 8.37	
6 197-232	Feet (Pack of 4)	The feet keep the unit from sliding along the undershelf. Replace when damaged	\$ 6.70	
7 66-045S	Strain Relief f/Power cord	Helps prevent power cord from being pulled out of steamer	\$ 3.36	
8 625-197S	Replacement Water Tube Kit	Replace if blockage in tube disrupts water from valve entering the platen. Includes: water tube, bushing and cleaning brush	\$ 52.76	
9 88-497S	Mini-jack Calibration Port	Port to put pyrometer in order to calibrate steamer's temperature. Replace if damaged	\$ 6.70	
10 625-064S	Top Plate	Slides into steamer chamber. Replace when lost or damaged	\$ 30.12	
11 625-207S	Hi-Limit Thermostat	Prevents unit from overheating by shutting itself down if max temp is reached. Replace if steamer overheats	\$ 50.16	
12 625-319S	Water Valve Assy. *** NEW ***	Includes improved water valve and new vented backplate, Controls flow of water into unit. Replace when water tube is in good condition, but no water reaches the steamer	\$ 151.84	
13 625-318S	Water Valve Connector	Connects water tube to water valve. Replace if damaged or when gray fitting is lost	\$ 21.10	
14 65-059S	Relay, 40A	Helps regulate the temperature. Replace if steamer is not heating	\$ 82.97	
15 625-323S	Power Board	Regulates power to unit. Replace when steamer is getting power and switch is OK, but steamer is not functioning	\$ 179.28	
16 625-065S	Venturi Plate	Plate with holes that water passes through on way to buns. Replace when lost or damaged	\$ 40.15	
17 625-082S	Probe, 1000 Ohm RTD	Measures temperature at platen	\$ 70.70	
18 72-386S	Line Cord Assembly	Power cord. Replace when evidence of damage exists or when power is not reaching unit	\$ 150.36	
20 625-253S	Regulator Assembly Kit	Regulates how much water goes to steamer. Includes water regulator, pressure gauge, water strainer, mounting hardware and connection fittings. Replace when regulator cannot hold water pressure.	\$ 175.45	
21 625-097S	Spatula Handle Kit	Replace when spatula handle is broken	\$ 19.48	
22 86-359S	Male Quick Disconnect Fitting	Connects waterline to regulator. Replace when leaking	\$ 16.24	
- 86-365S	Water Strainer Kit	Strains impurities from water. Includes strainer body, cap and screen	\$ 25.98	
- 625-204S	Display/Control Board	Replace when board is damaged. Symptoms include, no display, no steam cycles	\$ 119.33	
- 625-196S	Platen Bushing	"Black top hat" that is inserted into the platen before the water tube	\$ 19.48	
- 625-324S	O-ring For Male QD (Pkg of 5)	Seals Quick Disconnect. Replace as needed	\$ 4.05	

Order Online, 24 Hours a day at mcd.kitchen24.com



PHONE 1-800-521-3987

FAX 1-248-293-5113

EMAIL SalesHKN@hkdallas.com



**PRICES SUBJECT TO CHANGE AND EXCLUDE FREIGHT CHARGES
 NO RETURNS AFTER 30 DAYS
 NO MERCHANDISE MAY BE RETURNED WITHOUT A RETURN AUTHORIZATION NUMBER
 OUTBOUND FREIGHT PLUS 15% RESTOCKING CHARGE MAY BE APPLIED TO ANY RETURNED ITEMS

1/4/2006 Rev 1